

BAXTER HEALTH

(870) 508-1000
baxterhealth.org

There are a lot of elevators at Baxter Health, and it can be confusing! **Elevators A, B and C all go to the 1st, 2nd, and 3rd Floors. Elevator B is the only elevator that goes to the 4th, 5th, and 6th Floor.** By using the elevators selected below, you will end up closest to the units listed.

ELEVATOR A

2nd Floor: Women & Newborn Care Center (Rooms 2301-2332)
3rd Floor: Acute Inpatient Rehab (Rooms 3301-3323)

ELEVATOR B

2nd Floor: ICU/2 South (Rooms 2401-2427)
3rd Floor: Adult Behavioral Health (Rooms 3401-3432)
4th Floor: 4 South (Rooms 4401-4431)
5th Floor: 5 South (Rooms 5401-5432)
6th Floor: Hensley Behavioral Health (Rooms 6401-6423)

ELEVATOR C

2nd Floor: 2 West/ARU, Surgery, Medical Arts Building
3rd Floor: 3 West (Rooms 3501-3535)

ELEVATOR D (Medical Arts Building)

Ground Floor: Foundation, Physician Offices
1st Floor: Administration, Physician Offices
2nd Floor: Surgery, Pre-Surgery Testing and Registration, Physician Offices
3rd Floor: Physician Offices

Room# _____

To find a patient's room number, ask at an Information Desk or call (870) 508-1000 after hours.

2nd Floor

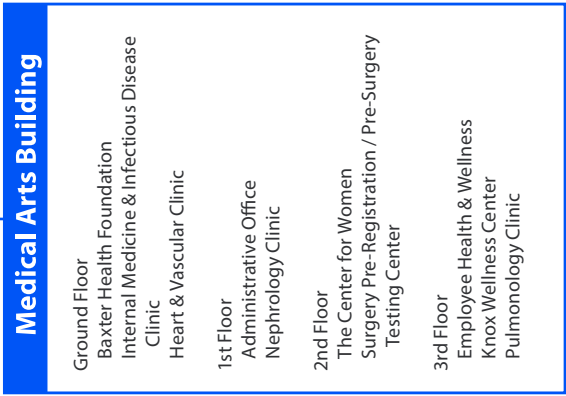
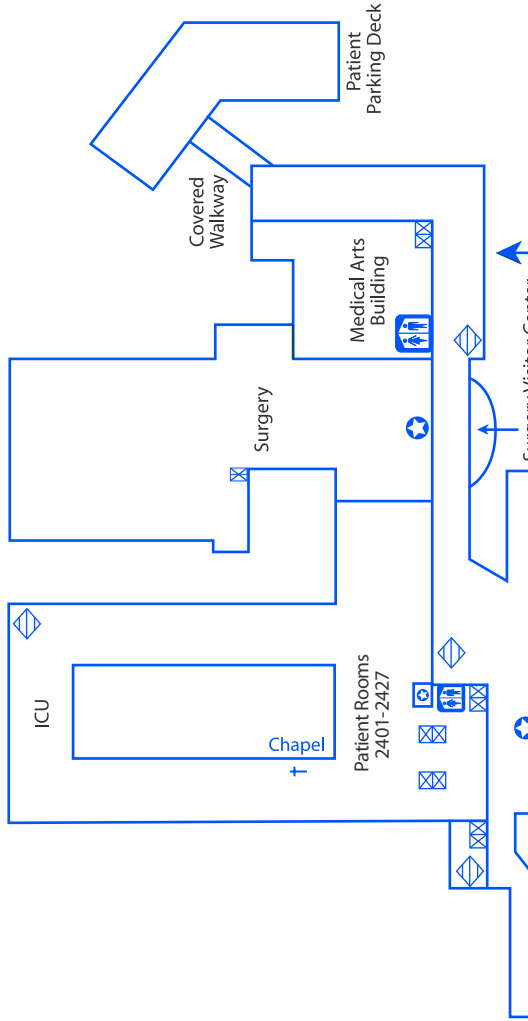

3rd Floor

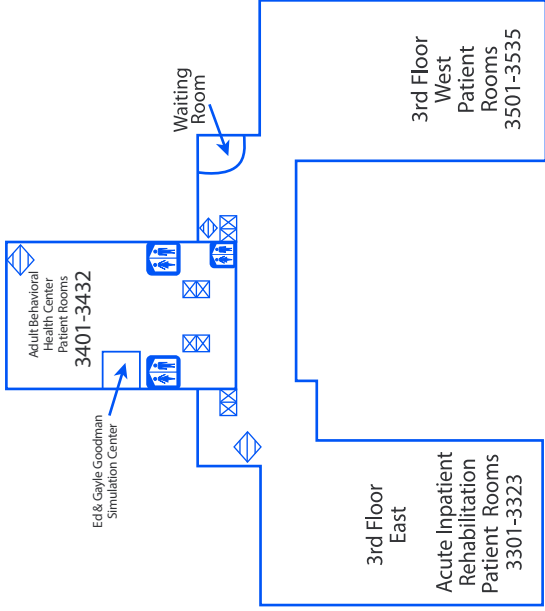

4th Floor

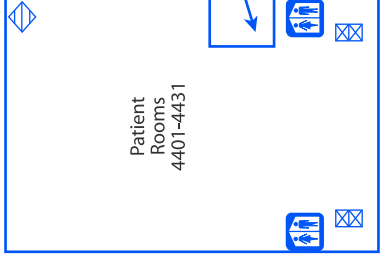

5th Floor

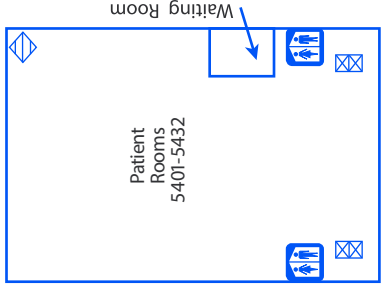

6th Floor

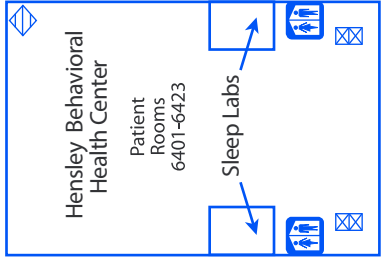

BAXTER HEALTH

(870) 508-1000
baxterhealth.org

Key

- Elevators
- Restrooms
- Information Desk
- Stairs